



**COUNCIL WORKSHOP 8.15.17**

**5:00 PM**

**PARKS NIGHT @ CITY HALL**

# R.A. LONG PARK IMPROVEMENTS

## STATUS OF ENHANCEMENTS TO PARK PLAZA

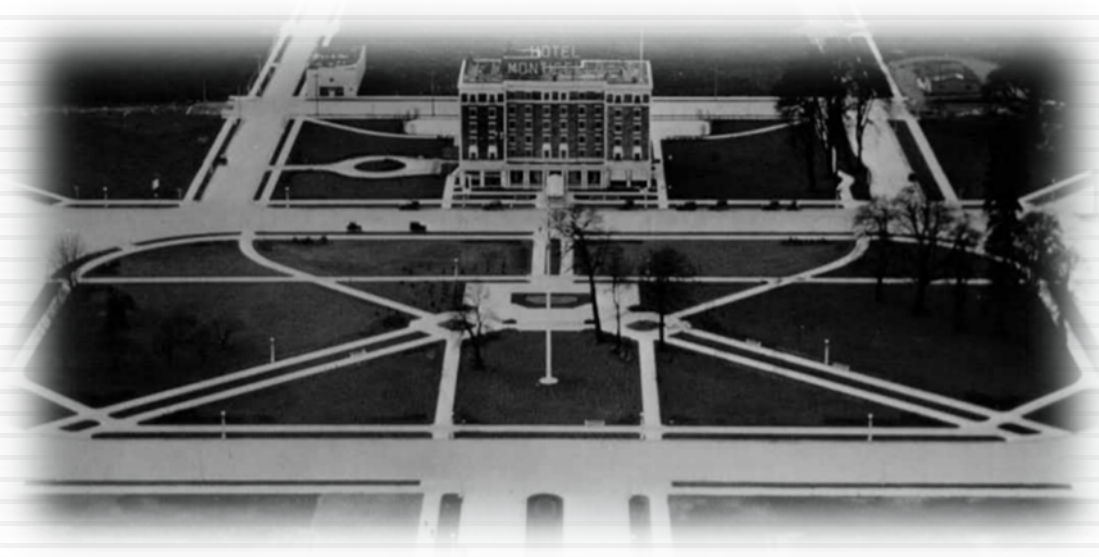
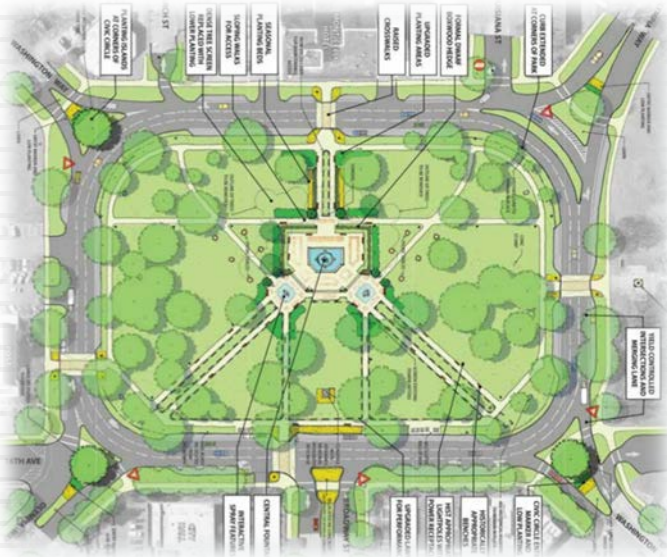

# R.A. LONG PARK UPGRADES - HISTORY

- RA Long Master Plan – completed 2010
  - ▣ Open house; public input; HPC and Park Board approval; Council adopted plan
- Park Improvements – Phase 1
  - ▣ Relocate RA Long bust – completed 2015
  - ▣ Replace central concrete plaza, construct water fountain, provide ADA approach to plaza, lighting – project advertised in 2016; not awarded due to funding shortage
  - ▣ Central concrete plaza and portions of lower plaza removed to eliminate safety hazards – completed 2016

# R.A. LONG PARK - CONSIDERATIONS

- Goals for the Park
- Consider Park Feature Options
  - Fountain
  - Gazebo or pavilion
  - Eliminate concrete plaza
- Master Plan Update
  - Public Input
  - Historic Preservation Commission and Parks Board approval
  - City Council

# R.A. LONG PARK - COST ESTIMATES

**Option 1 – Replace upper and lower plaza and steps; new colored red and aged grey concrete; construct fountain; ADA access to plaza**

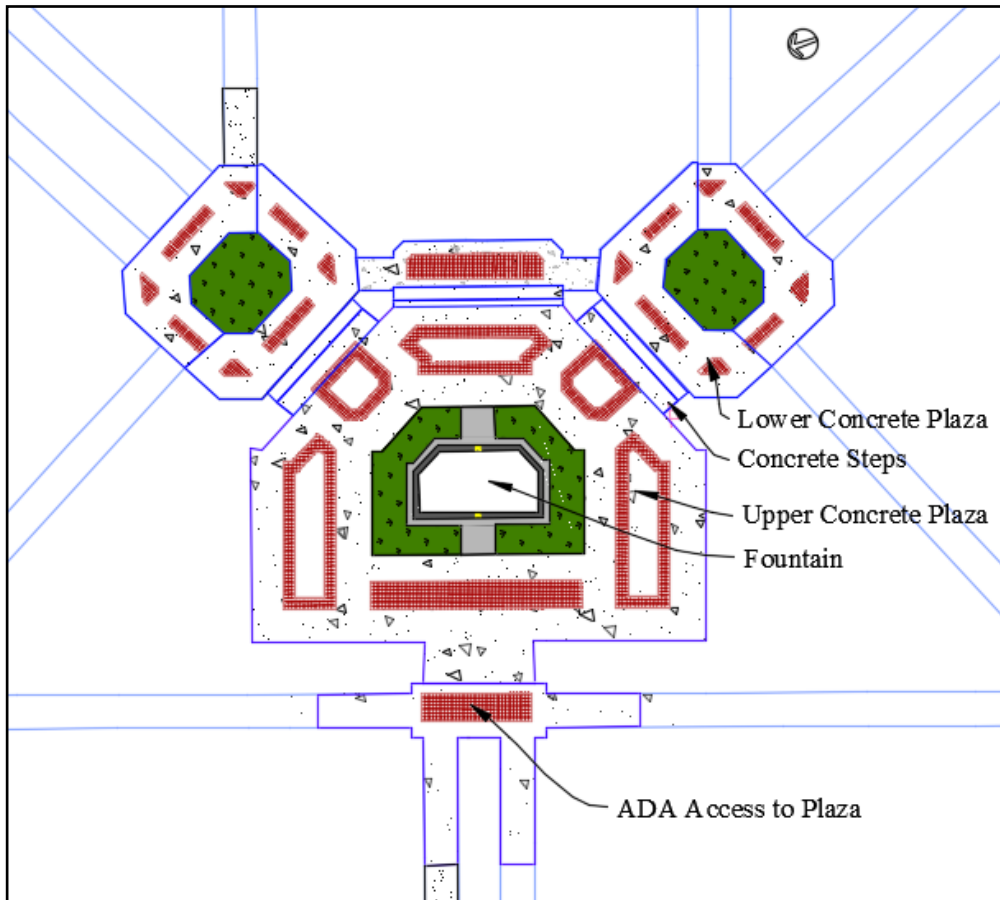

- Updated cost estimate with concrete plaza and fountain feature
- Total Cost  $\approx$  \$746,000
  - Engineering: \$46,000
  - Construction: \$600,000
  - Contingency: \$100,000

# R.A. LONG PARK - COST ESTIMATES

**Option 2 - Replace upper and lower plaza and steps; new colored red and aged grey concrete; gazebo; ADA access to plaza**

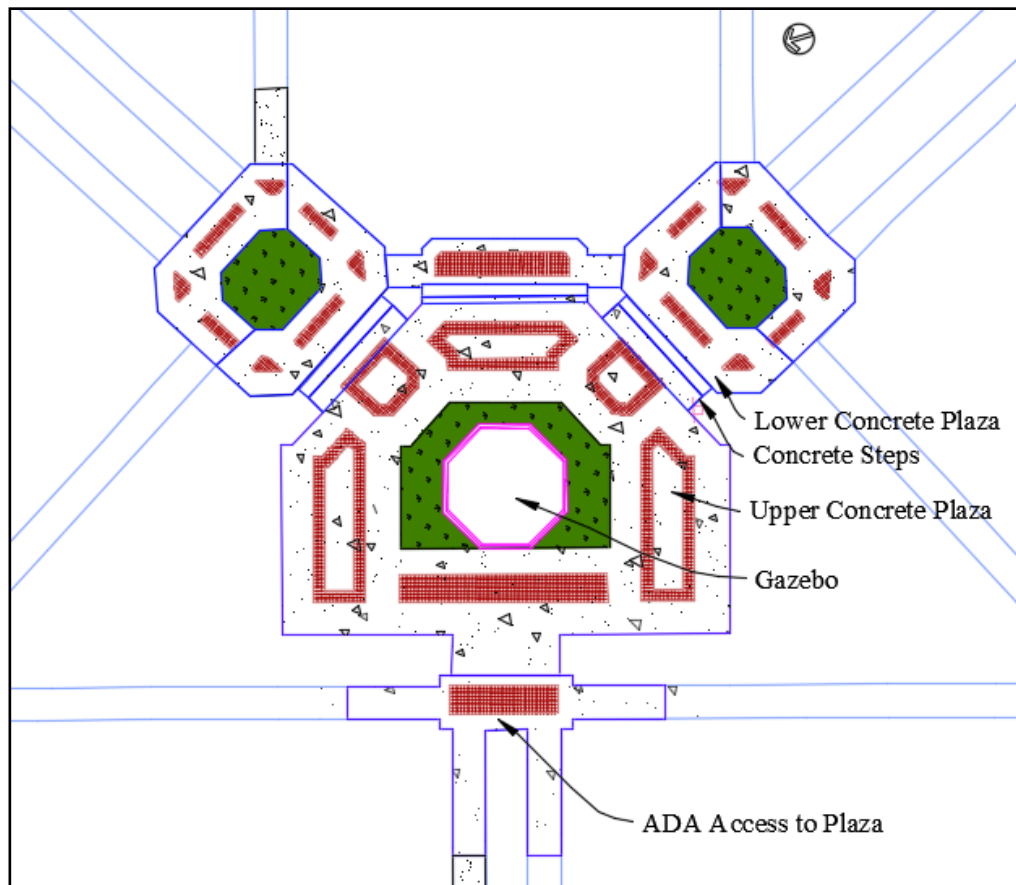

- Concrete plaza and gazebo
- Gazebo options: oval, rectangular, octagon, wood, vinyl, benches, lighting, electrical
- Cost estimate includes: standard 30' octagonal vinyl gazebo with benches, electrical packet and outlets on concrete pad (no gazebo floor)
- Total Cost  $\approx$  \$680,000
  - Engineering: \$60,000
  - Construction: \$525,000
  - Contingency: \$95,000

# R.A. LONG PARK - COST ESTIMATES

**Option 3 – Replace lower concrete plaza; new colored red and aged grey concrete; upper concrete plaza replaced with grass; gazebo with concrete sidewalk approach and ADA for access**

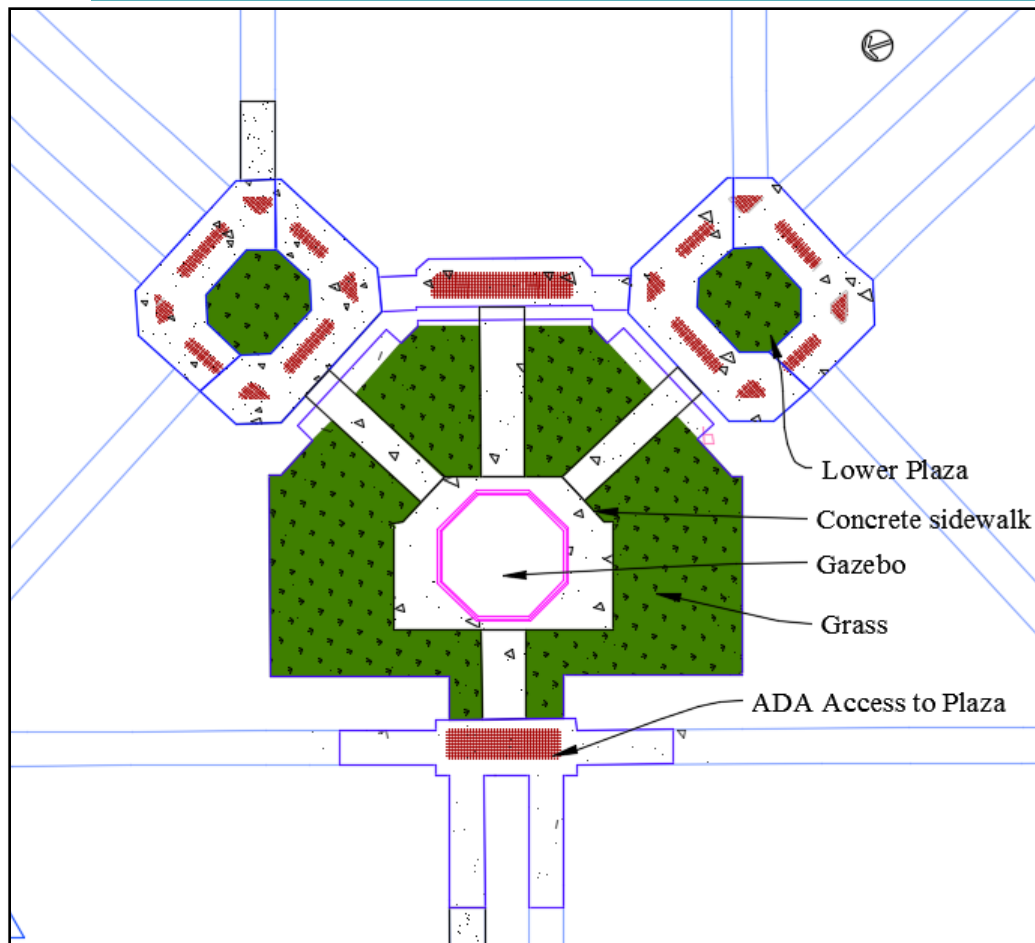

- ❑ Gazebo with grass plaza
- ❑ Gazebo options: oval, rectangular, octagon, wood, vinyl, benches, lighting, electrical
- ❑ Cost estimate includes: standard 30' octagonal vinyl gazebo with benches, electrical packet and outlets on concrete pad (no gazebo floor)
- ❑ Total Cost  $\approx$  \$534,000
  - Engineering: \$60,000
  - Construction: \$398,000
  - Contingency: \$76,000



# R.A. LONG PARK – GAZEBO EXAMPLES





# R.A. LONG PARK – PAVILION EXAMPLES



# R.A. LONG PARK - COST ESTIMATES

## Other recommended park improvements

- Upgrade park lighting system and power receptacles
  - \$63,000
- Upgrade electrical service
  - \$56,000
- Additional sidewalk repairs in park to remove safety hazard
  - \$75,000

# R.A. LONG PARK - FUNDING STATUS



- Current Available Funding - \$375,000
  - Kuntz Family Trust Fund
    - \$300,000
  - Donation
    - \$75,000 pledge
  - State Capital Budget Request
    - \$296,000 (legislature has not adopted capital budget)
- Prior Expenditures
  - \$100,000 - project design/bidding; R.A. Long bust relocation; plaza removal

# R.A. LONG – POTENTIAL ADDITIONAL FUNDING SOURCES

- Allocate funds from other capital projects
  - ▣ Playground equipment replacement (budgeted at \$45,000 in each of 2017 and 2018; \$45,000 intended as CDBG match for Kellogg Park playground)
  - ▣ ADA Improvements (budgeted at \$100,000 in 2018)
  - ▣ Others?
- Apply for grant opportunities
  - ▣ Heritage Capital Project Grant - funding available in 2019-2021 state budget if appropriated
  - ▣ Kuntz Memorial Trust Fund



# R.A. LONG PARK - NEXT STEPS

- Confirm or update project master plan
  - ▣ Desired uses and features
  - ▣ Future maintenance
  - ▣ Historic preservation
- Determine funding
- Determine project timeline
- Determine phasing
- Obtain Historic Preservation Commission and Parks Board concurrence

# DISCUSSION?

R.A. LONG PARK

# **2** **SPORTS FACILITIES**

**HISTORY, PRESENT, & FUTURE**

# HISTORY – SPORTS COMPLEXES

- **Archie Anderson Park – 1959**
  - City, Volunteers, Central Youth Baseball (\*Attachment A)
- **John Null Park – 1965**
  - Western Little League Baseball, City (\*Attachment B)
- **Roy Morse Park – 1972**
  - City, Babe Ruth Baseball (\*Attachment C)
- **Vandercook & John Null Tennis – 1978 (50s)**
  - City of Longview (\*Attachment D)
- **7<sup>th</sup> Avenue Park – 1985**
  - Soccer/Softball Clubs, Lions Clubs, City (\*Attachment E)



## SPORTS COMPLEX HISTORY

1959

### Archie Anderson Park

- City
- Volunteers
- Central Youth  
Baseball



Archie Anderson, Alabama St at 21<sup>st</sup> & 22<sup>nd</sup>

# SPORTS COMPLEX HISTORY

1965

John Null Park

- Western Little League Baseball
- City



John Null, 2650 Pacific Way



# SPORTS COMPLEX HISTORY

1972

Roy Morse Park

- City
- Babe Ruth  
Baseball



Roy Morse, Reg Smith Drive

## SPORTS COMPLEX HISTORY



- 1978 (50s) - Vandercook & John Null Tennis
- City

Vandercook, 1416 21<sup>st</sup> Ave. (Left)  
John Null, 2650 Pacific Way (Right)



## SPORTS COMPLEX HISTORY

1985

### 7th Avenue Park

- Soccer Clubs
- Softball Clubs
- Lions Clubs
- City



7<sup>th</sup> Avenue Park, 920 7<sup>th</sup> Ave.

# FACILITY USE AGREEMENTS

## LEAGUES AGREE TO:

- Responsible for Field & Building Maintenance, Equipment, & Restrooms.
- Pay reduced 25% rates for Garbage, Electricity, & Water/Sewer
  - Resolution Nos 2192 & 2193
- Fund & Install Improvements/Repairs
- Provide Insurance/Health Permits

## CITY AGREES TO:

- Allow Use Free of Charge/Discount Utilities
- Maintain General Public Park Areas
- Act as Liaison and Support for Park Needs
- Provide Neighborhood Park Grant Funds

# CURRENT FACILITY CONCERNS

- ☐ Year Round Responsibility
- ☐ Security/Vandalism
- ☐ Restrooms
- ☐ Regular Maintenance
- ☐ Equipment Purchases
- ☐ Large Capital Improvements

# FUTURE OF SPORTS IN LONGVIEW

## CONTINUE ON SAME PATH

- ❑ Teams/Participants traveling out of City
- ❑ Loss of leagues
- ❑ Facility responsibility back to the City
- ❑ Degradation of facilities or removal

## MAKE A PLAN FOR THE FUTURE

- ❑ Determine goal and mission of the sports/park facilities
- ❑ Explore/Invest in park infrastructure for the future of the facilities
- ❑ What other cities are doing



# DISCUSSION?

SPORTS FACILITIES

**3**

# **OUTSIDE USERS OF PARKS**

**HISTORY, PRESENT, & FUTURE**

# HISTORY – PARK USE

- Historically, parks were seen as a place for passive use
- Organized events in the summer were discouraged except Go 4<sup>th</sup> & Concerts
- Fun Runs were coordinated in spring and fall to not interfere with summer park users
- The goal was not to turn parks into a marketplace
- User groups were turned away from parks as a place to hold events – noise/people
- Park Impact Concern— physical, monetary, labor

# RECENT CHANGES – PARK USE



- ❑ Special Event Permitting
- ❑ Increased P&R Events
- ❑ Increased Public & Private Events
- ❑ Boating Vendor
- ❑ Food Vendors
- ❑ Turning Parks into a Community Gathering Place
- ❑ Quality of Place/Tourism



# SPECIAL EVENT PERMITS

## □ **PRICING**

- Based on 5 Hour Event/Number of Attendees/Facility
  - Fundraising Event - Charging Admission
  - Non-Fundraising Event - Free Public Event
  - Sport Field Rentals

## □ **RULES & REGULATIONS**

- Insurance Requirements
- Vendor Requirements
- Park Rules
- Reimbursable Costs for Labor/Damage

## □ **EQUITY IN PERMITTING** – Same for all permit holders



# VISION FOR FUTURE USE



- ❑ Minimize Park Impact/Cost while maximizing use
- ❑ Fair & Equitable
- ❑ Permissible Activities
- ❑ Increased Partnerships
- ❑ What other Cities are doing

# DISCUSSION?

OUTSIDE USERS OF PARKS