

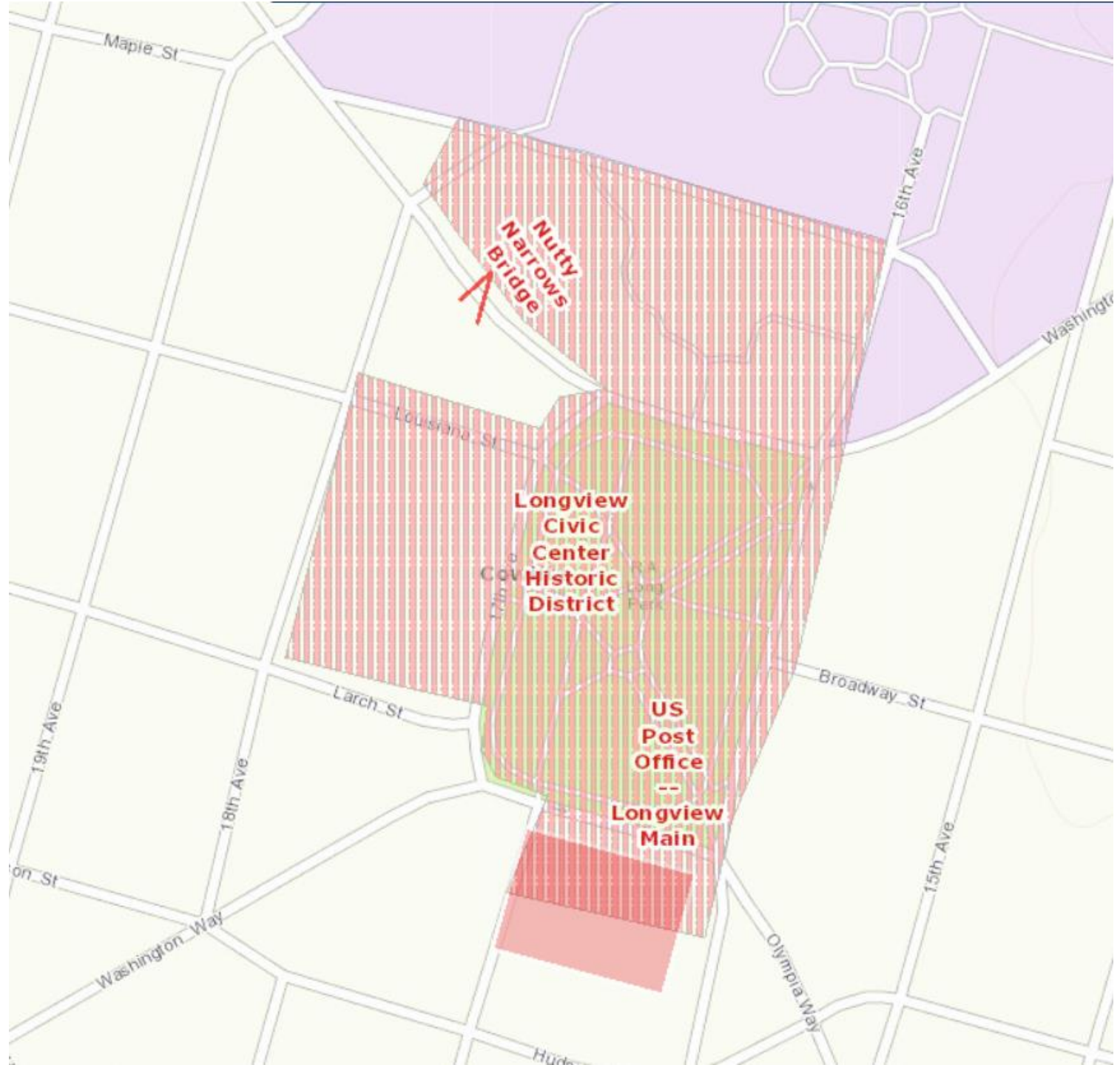

R.A. LONG PARK MASTERPLAN

February 25, 2010

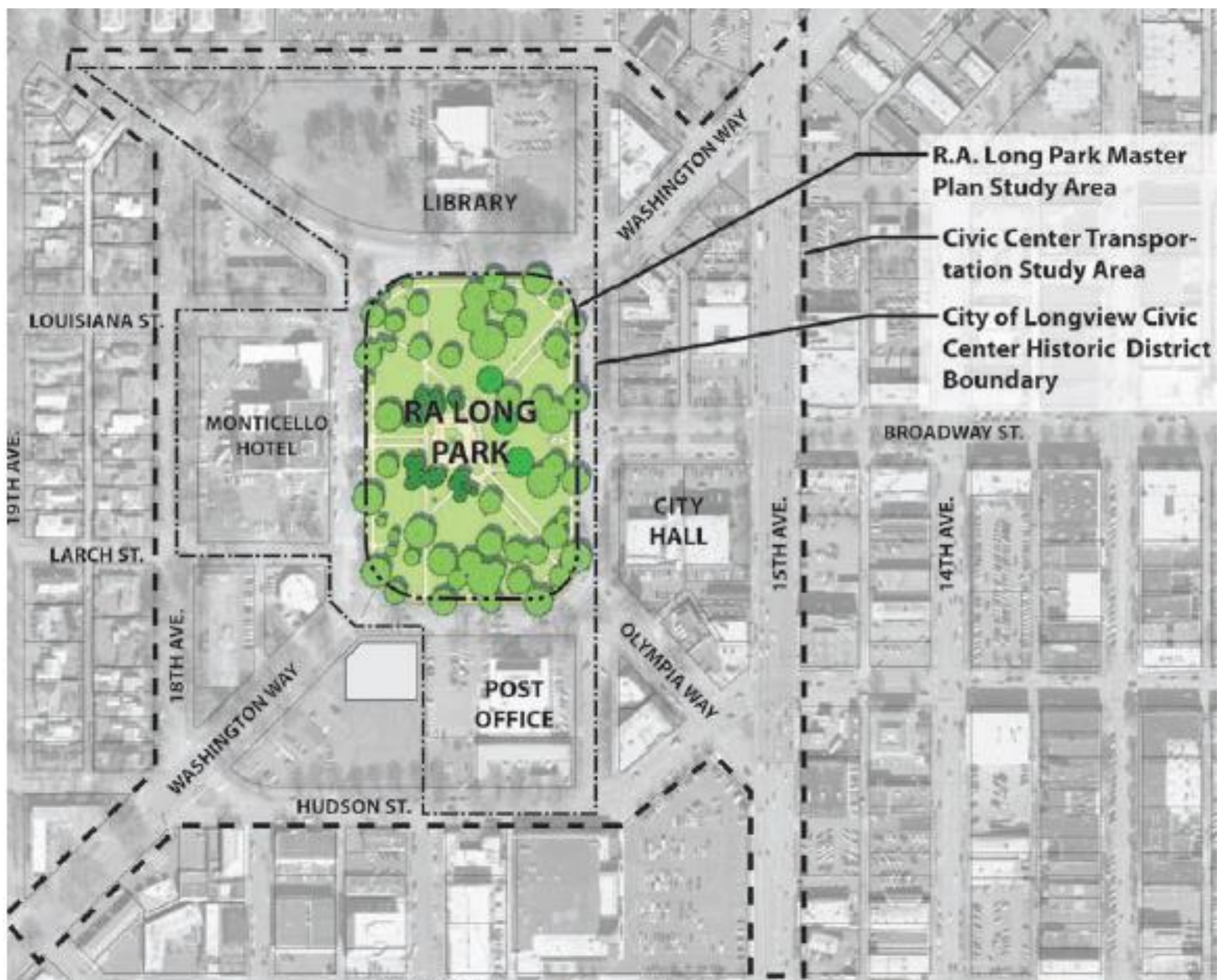





RA Long Park circa 1925



THE CITY OF LONGVIEW

FOUNDED 1923

LONGVIEW WASHINGTON 98632

January 12, 1990

Mayor Dennis Weber
P. O. Box 128
Longview, WA 98632

RE: Longview Historic Register

I, Dennis Weber, as owner/legal representative of the Jefferson Square, located at 1400 17th Avenue, request inclusion on the Longview Historic Register. I understand that a Public Hearing will be held on February 15, 1990, in the Small Conference Room, 2nd Floor, Longview City Hall, 1525 Broadway at 4:00 p.m. to consider nomination into the Register.

Signed

Dennis Weber

Date

2/8/90

LONGVIEW REGISTER OF HISTORIC PLACES

R. A. LONG PARK
CIVIC CENTER

Significant Historic Features

A. Exterior

1. Features that should be Preserved and Maintained

Original layout and design of concrete walks.
Original plantings made at time of park construction.
Stone historic markers
R. A. Long Bust (Non- Historic)
Terrace
Sundial

2. Features that would be Desirable to Restore to the Original

C. Non-Historic Additions

Metal Benches

Light Poles

D. Special Notes

Metal benches and light poles should be replaced with designs and materials reflective of the historic period.

Significant Historic Features

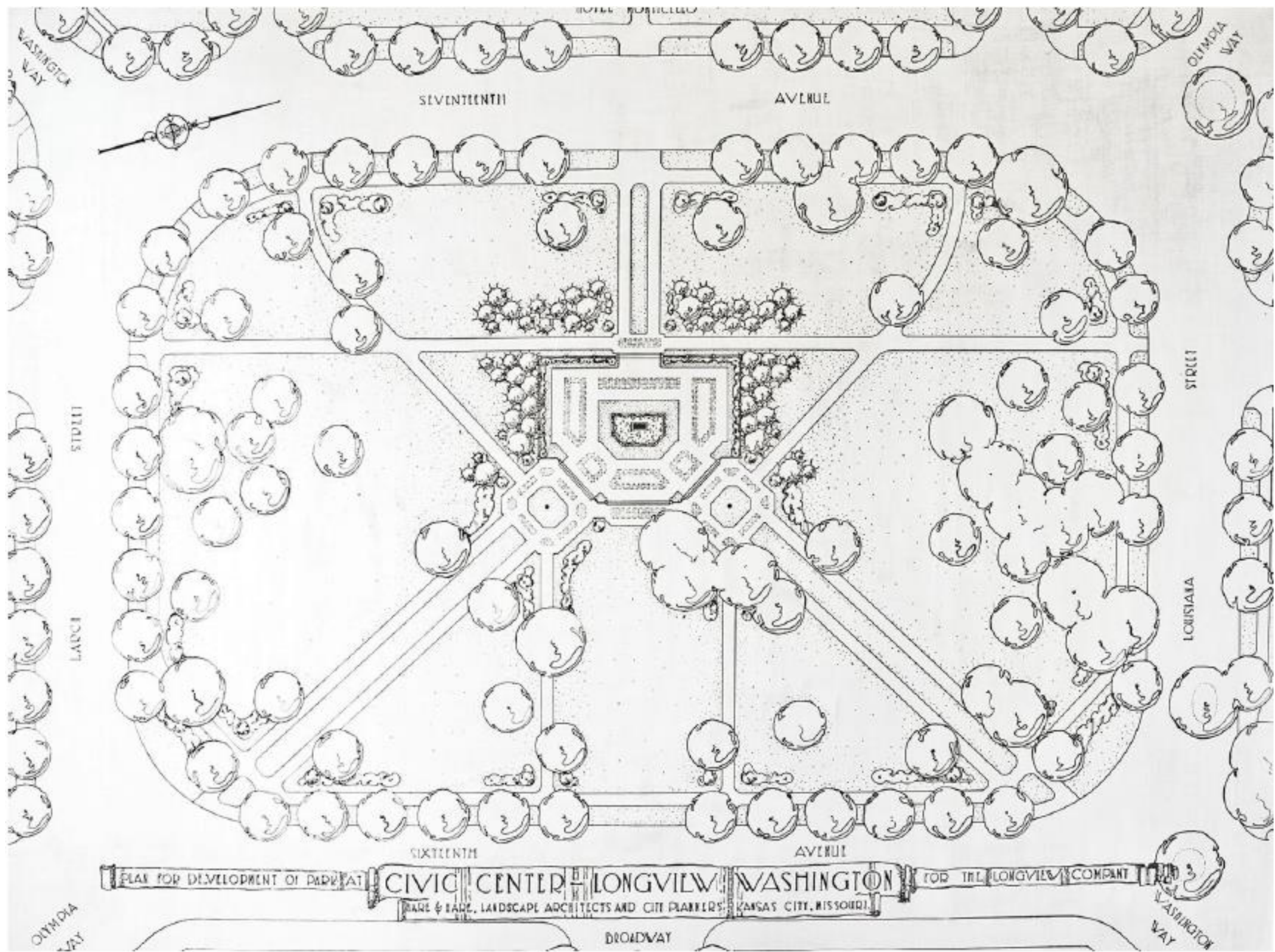

rendering of how the finished park was meant to look (figure 1.8). To give additional emphasis to the raised terrace, S Herbert Hare noted (in an article in Parks & Recreation Journal published eight years after the Park's completion):

"One of the interesting features of the design is a raised terrace near the center of the park. [...] The central area of the terrace, now in flower bed, is intended in the future to be occupied by some monumental sculpture or fountain"

Situated between the newly completed 'Hotel Monticello' (figure 1.9), the library, the post office, and the future City Hall, the Park was also conceived as a place for formal gardens to showcase civic pride (figure 1.10) and a space to accommodate important events and civic gatherings (figure 1.11).



Figure 1.7 Central Raised Terrace of R.A. Long Park, circa 1925

Historic Preservation Commission motion on revised park project:

The commission discussed the 3 options for RA Long park project.

- Option 1: Replace upper and lower plaza in gray/ red concrete; add fountain
- Option 2: Replace upper and lower plaza in gray / red concrete; add gazebo
- Option 3: Replace upper plaza in grass and lower plaza in concrete; add gazebo

The commission supported Option 2 to replace the upper and lower plaza, and will accept regular concrete with stamping in place of the red concrete to save costs.

The commission found the following elements of the plaza significant and needing to be replaced or preserved:

- The plaza elevation
- The plaza shape / geometry
- The scoring / texture of the concrete to match original
- The hedge border

The commission prefers the oval or octagonal gazebo rather than a pavilion and a gazebo will need design review by the commission.

R.A. LONG PARK IMPROVEMENTS – REVISED PLAN

- Replace upper and lower plaza with regular concrete and texture; install gazebo in the center of upper plaza

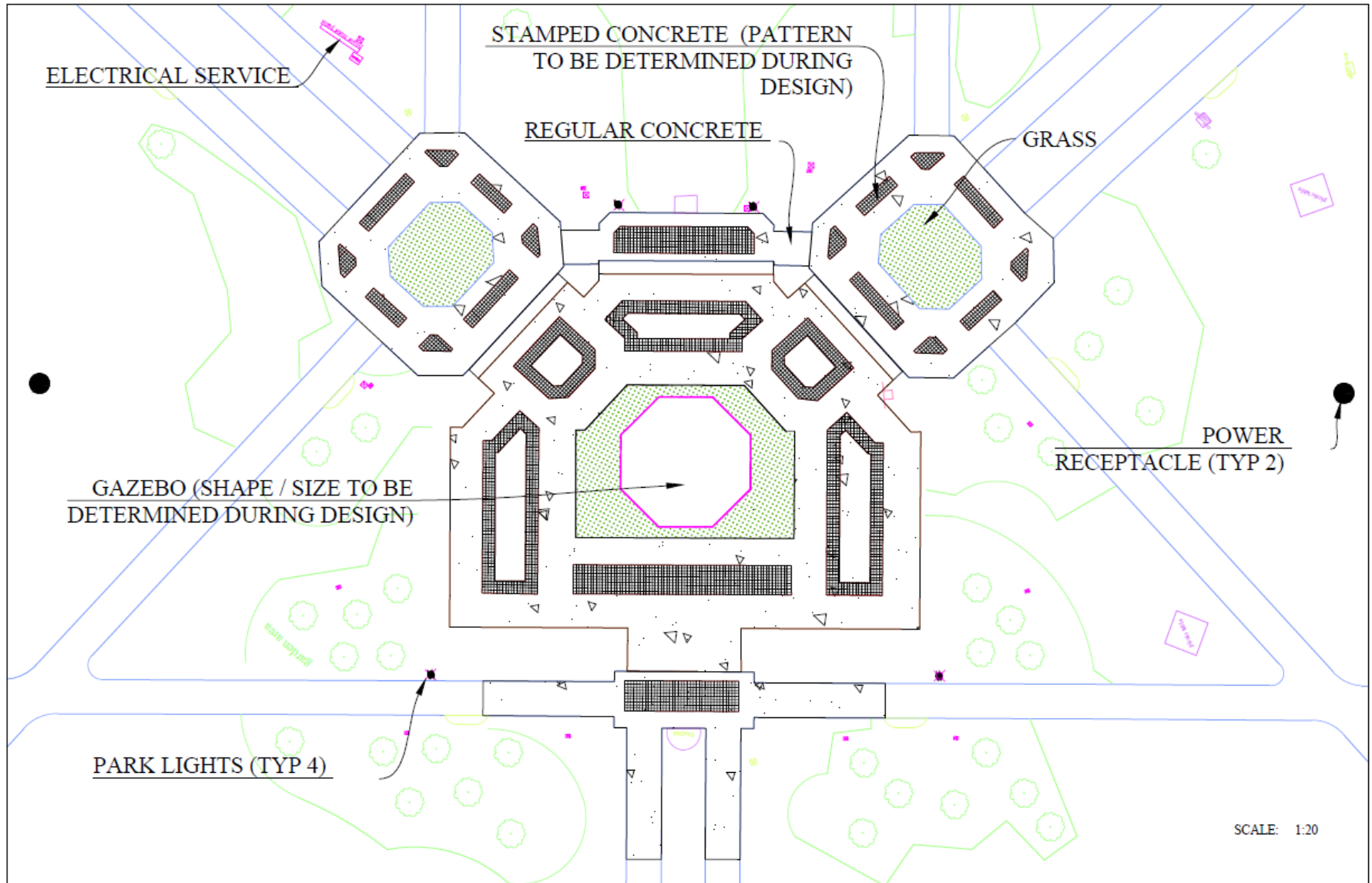

R.A. LONG PARK IMPROVEMENTS – REVISED COST ESTIMATE

- New cost estimate reflects savings for no colored concrete and reduced concrete thickness for upper plaza

Total Project Cost ≈ \$715,000

- ❖ Engineering ≈ \$60,000
- ❖ Construction ≈ \$570,000
 - Plaza /Gazebo ≈ \$453,000
 - Park Lighting ≈ \$61,000
 - Elec. Service ≈ \$56,000
- ❖ Contingency ≈ \$85,000

Current Available Funding ≈ \$375,000

Deficiency ≈ \$340,000

Potential additional savings

- ❖ Eliminate new event power receptacles (two)
 - Cost savings ≈ \$17,300
 - Total project cost with this savings ≈ \$697,700

R.A. LONG PARK IMPROVEMENTS – FUNDING SUMMARY



- Estimated Project Cost - \$715,000
- Current Available Funding - \$375,000
 - Kuntz Family Trust Fund - \$300,000
 - Donation - \$75,000 pledge for gazebo
- Budget Deficiency - \$340,000



Potential Additional Funding Sources

- Kuntz Family Trust
- State Capital Budget Request - \$296,000 (legislature has not adopted capital budget)
- Heritage Capital Project Grant – (grant available in 2019-2021 state budget if appropriated; application due May 2018)
- Capital Projects Fund

R.A. LONG PARK IMPROVEMENTS – NEXT STEPS

- Confirm project design
- Determine need for:
 - RA Long Park Master Plan update
 - Public outreach
- Determine additional funding sources
- Determine project timeline

DISCUSSION
& Direction to Staff