



May 2, 2018

Jennifer DesArmo
Harlie's Angels
P.O. Box 1834
Castle Rock, WA 98611

Re: Critical Areas Determination and Impact Analysis for Proposed Harlie's Hoops Basketball Court at Teen Center, Lake Sacajawea, Longview Washington, in accordance with *Appendix A, Shorelines Critical Areas Regulations of the City of Longview Shoreline Management Program, 2015*.

Dear Jennifer,

Ecological Land Services, Inc. (ELS) conducted a site visit on April 25, 2018 at the location of a proposed basketball court located immediately east of the Teen Center facility on the north side of Lake Sacajawea, near the intersection of Kessler Blvd and 21st Avenue, in Longview, Washington. The reason for the site visit was to determine if any critical area impacts would occur as a result the proposed construction of a 50 foot by 110 foot covered basketball court. Lake Sacajawea is a Shoreline of the State in accordance with the *City of Longview Shoreline Management Program, 2015 (SMP)*. Critical areas (CAR) are regulated in Appendix A of the SMP.

Site Description

The proposed basketball court will be located just east of the fenced area which surrounds the Teen Center facility along Kessler Boulevard on the north side of Lake Sacajawea. The building will be oriented with its longer side north-south. The current site consists of mowed lawn, a picnic bench, one white bark birch tree, and several other ornamental shrubs located near the perimeter of the proposed building. At a minimum, the white bark birch tree will have to be removed to facilitate construction of the building. Other trees and shrubs may need to be

pruned or moved to allow construction. In addition, the picnic bench will also need to be moved. The proposed building is located approximately 90 feet from Lake Sacajawea at its closest point to the east. See attached photos for views of the proposed project site.

Critical Areas

We found no critical areas located within the proposed building footprint. No wetlands, Oregon white oak habitat, or aquatic habitats occur within this building footprint area. Lake Sacajawea is a designated *Fish and Wildlife Habitat Conservation Area per Section IV of the CAR. In section G. Riparian Zones. Table IV.G.1. Standard Riparian Buffer Width, Reach 5 – Lake Sacajawea_* has a 200 foot buffer. The buffer from Lake Sacajawea, a shoreline and water of the state, is effectively interrupted by a well-traveled impervious trail (also used as a road for park maintenance equipment) running around the lake and in between the lake and the site, as well as mowed lawn, landscape area, and non-native trees. The impervious trail functionally isolates the project site from the buffer of Lake Sacajawea in accordance with *Section G.4 of the CAR.*

The entire area of the proposed building is heavily used currently for active public recreation. The proposed building will not change this use, in fact, will increase recreational opportunities. The project also meets *Section IV.B.3 by locating buildings and structures in a manner that preserves the majority of habitat or minimizes adverse impacts and Section IV.B.8. by preserving trees to the extent possible.*

The project may generate some additional roof-generated stormwater runoff, but no polluted runoff such as those created by parking lots or roads. As Lake Sacajawea is a water body that is controlled by an outlet, no hydrologic impacts (for example from flooding) are anticipated from some nominal addition of roof runoff. Water quality treatment of the roof runoff can be obtained through grass filter strips where the gutters discharge.

Impact Assessment

No critical area impacts will occur as a result of this project, however, some measures are recommended to avoid or compensate environmental impacts to this outdoor recreational area:

1. Replace, relocate or compensate for any trees or shrubs removed for the building by following park facility guidelines.
2. Relocate the existing picnic table to another area.
3. Use grass filter strips to infiltrate or otherwise treat roof runoff.

Summary

In summary, no critical areas impacts will occur as a result of this project. The proposed project will replace a heavily used grass-dominated public recreation area with a heavily used building housing a basketball court for public recreation and sport. The impervious trail located between the lake and the project site functionally isolates the project site from the buffer of Lake Sacajawea in accordance with *Section G.4 of the Critical Areas Regulations of the Longview SMP*. Impacts to the few trees and shrubs can be mitigated by moving or replacing the lost ornamental vegetation to other areas of the park surrounding Lake Sacajawea.

Thank you for the opportunity to provide this assessment and feel free to contact me if you have any questions.

Sincerely,

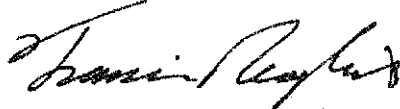
A handwritten signature in black ink, appearing to read "Francis Naglich", written in a cursive style.

Francis Naglich, Principal

Attachments: 3 Photos



View toward southeast corner of proposed covered building.



View of tree to be removed in location of north part of proposed building.



View from proposed building location toward Lake Sacajawea.

Harlie's Hoops Sports Courts Vicinity Map

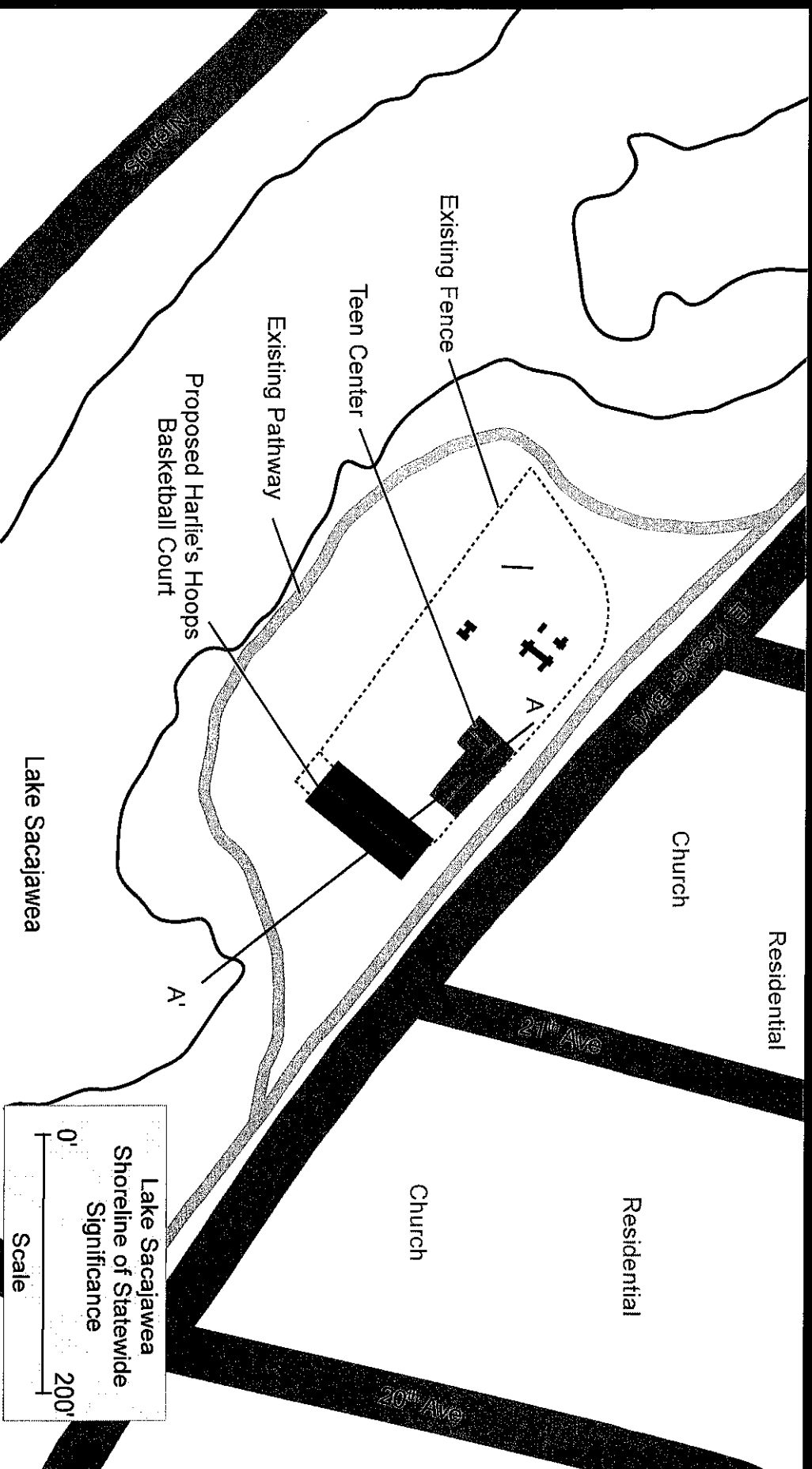

Harlie's Hoops Sports Courts Cross Section View

